

CST156*156-P-72- (315~340W)

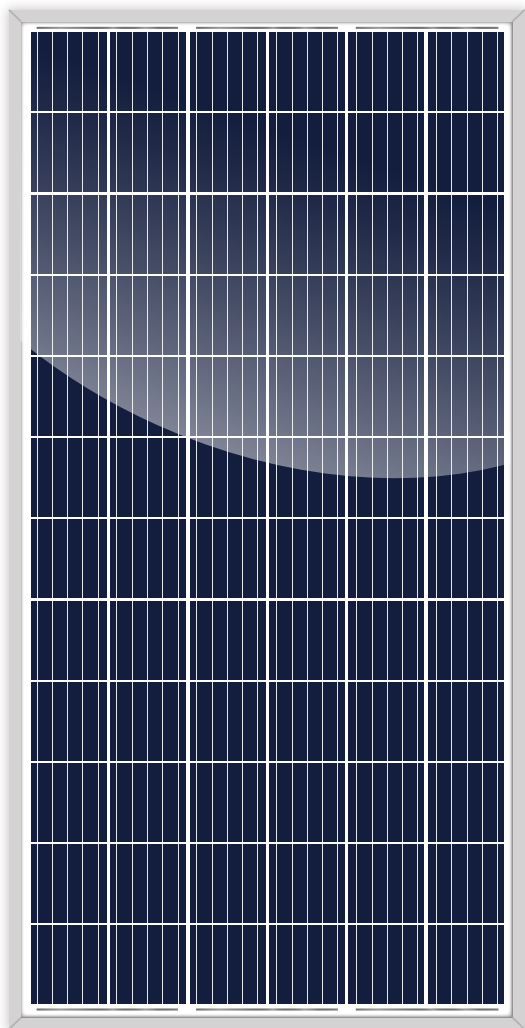

Standard 72 Cells Polycrystalline PV Module



Positive tolerance

Positive tolerance of up to 5W delivers higher output reliability



Excellent weak light performance

More power output in weak light condition, such as haze, cloudy and morning



Certified to withstand

wind load (2400 Pascal) and snow load (5400 Pascal)



12 years Product Warranties

overlength quality warranties age limit



25 years Performance Guarantee

10-YEAR 91.2% Maximum Output

25-YEAR 80.7% Maximum Output

Manufactured in china

PRODUCT CERTIFICATES



IEC61215 : 2016
IEC61730 : 2016



ISO 9001: Quality management system



ISO 14001: Standard for environmental management system



OHSAS 18001: International standard for occupational health and safety assessment system

MANAGEMENT SYSTEM

Industry leading product linear quality assurance

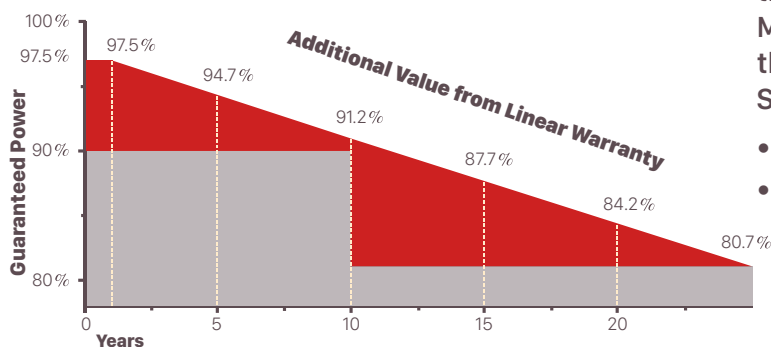

• 97.5% in the first year, thereafter, for years two (2) through twenty-five (25), 0.7% maximum decrease from MODULE's nominal power output per year, ending with the 80.7% in the 25th year after the defined WARRANTY STARTING DATE.

- 12 -year product warranty
- 25-year linear performance warranty

72Cells:CST156*156-P-72-(315~340W)

Electrical Characteristics	CST156*156-P-72-315W		CST156*156-P-72-320W		CST156*156-P-72-325W		CST156*156-P-72-330W		CST156*156-P-72-335W		CST156*156-P-72-340W	
	(STC)	(NOCT)	(STC)	(NOCT)	(STC)	(NOCT)	(STC)	(NOCT)	(STC)	(NOCT)	(STC)	(NOCT)
Maximum Power - Pmax(W)	315 (0/+5W)	238	320 (0/+5W)	242	325 (0/+5W)	244	330 (0/+5W)	246	335 (0/+5W)	250	340 (0/+5W)	254
Open Circuit Voltage - Voc(V)	45.60±5%	43.2	45.80±5%	43.7	46.00±5%	44.0	46.20±5%	44.2	46.40±5%	44.4	46.60±5%	44.6
Short Circuit Current - Isc(A)	8.99±5%	7.29	9.07±5%	7.30	9.16±5%	7.34	9.25±5%	7.38	9.34±5%	7.43	9.43±5%	7.98
Voltage at Pmax-Vmp(V)	37.20	34.3	37.40	34.7	37.60	35.0	37.80	35.3	38.00	36.5	38.20	35.8
Current at Pmax-Imp(A)	8.47	6.84	8.56	6.86	8.64	6.91	8.73	6.97	8.82	7.02	8.90	7.05
Module Efficiency-ηm(%)	16.23		16.49		16.75		17.01		17.26		17.52	

Mechanical Specifications	
External Dimensions	1960*990/992*40mm
Weight	21.5kg
Solar Cells	poly crystalline 156.75*156.75mm (72pcs)
Front Glass	3.2 mm tempered glass low iron
Frame	Anodized aluminum alloy
Junction Box	IP67
Output Cables	4.0mm ² , cable lenght:1100mm
Connector	Ningbo Guangzhixing Photovoltaic Technology PV-GZX1500
Mechanical Load/front	a:5400pa b:3600pa
Mechanical Load/back	a:2400pa b:1600pa

Safety factor	1.5
Maximum System Voltage(V)	1500
Maximum Series Fuse Rating(A)	15
STC: Irradiance 1000 W/m ² , module temperature 25 °C, AM=1.5; Best in Class AAA solar simulator (IEC 60904-9) used, power measurement uncertainty is within +/- 3% NOCT: Irradiance 800 W/m ² , ambient temperature 20 °C, AM=1.5, wind speed 1 m/s; Best in Class AAA solar simulator (IEC 60904-9) used, power measurement uncertainty is within +/- 3%	

Packing Configuration		
Container	20'GP	40'GP
Pieces per pallet	26	26
Pallets per container	10	24
Pieces per container	260	624

Temperature Characteristics	
Pmax Temperature Coefficient	-0.40 %/°C
Voc Temperature Coefficient	-0.32 %/°C
Isc Temperature Coefficient	+0.05 %/°C
Operating Temperature	-40~85 °C
Nominal Operating Cell Temperature (NOCT)	45±2 °C

Engineering Drawings

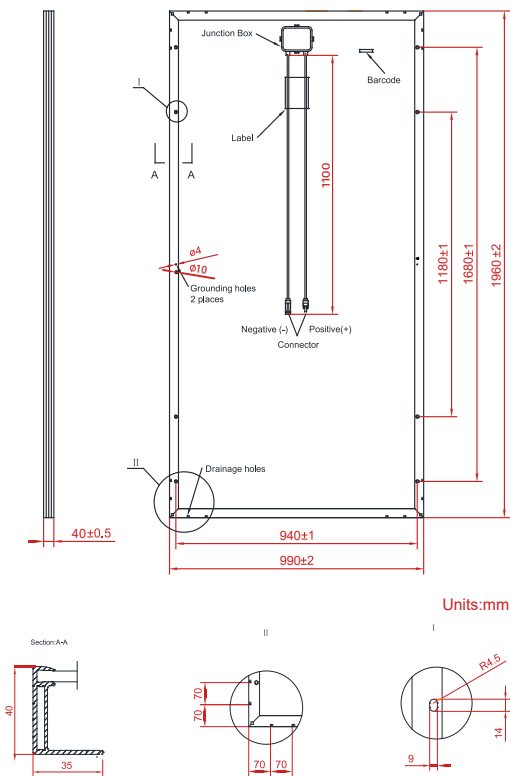

Temperature Dependence & Electrical Performance

