

## CST156\*156-M-72-(345~370W)

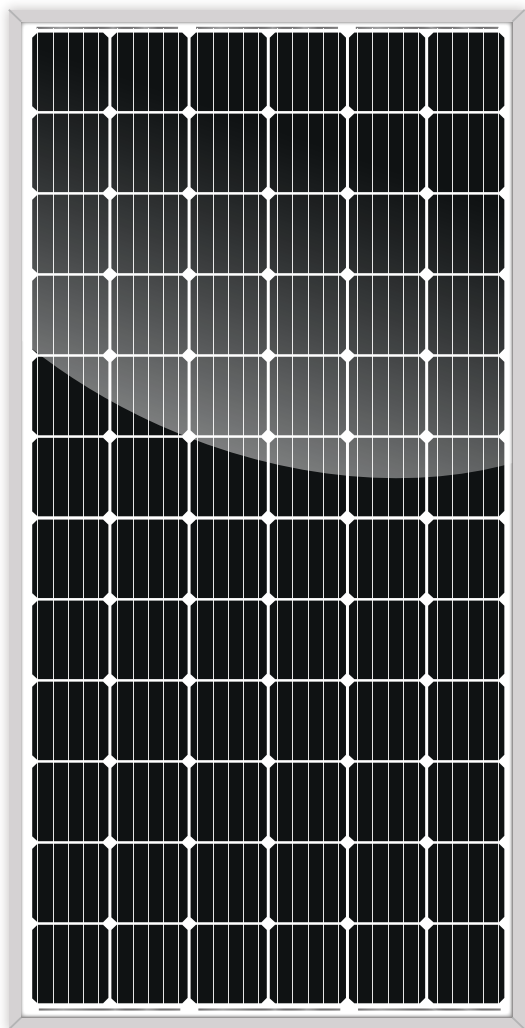

### Standard 72 Cells Monocrystalline PV Module



#### Positive tolerance

Positive tolerance of up to 5W delivers higher output reliability



#### Excellent weak light performance

More power output in weak light condition, such as haze, cloudy and morning



#### Certified to withstand

wind load (2400 Pascal) and snow load (5400 Pascal)



#### 12 years Product Warranties

overlength quality warranties age limit



#### 25 years Performance Guarantee

10-YEAR 91.2% Maximum Output

25-YEAR 80.7% Maximum Output

Manufactured in china

### PRODUCT CERTIFICATES



IEC61215 : 2016  
IEC61730 : 2016



ISO 9001: Quality management system



ISO 14001: Standard for environmental management system



OHSAS 18001: International standard for occupational health and safety assessment system

### Industry leading product linear quality assurance

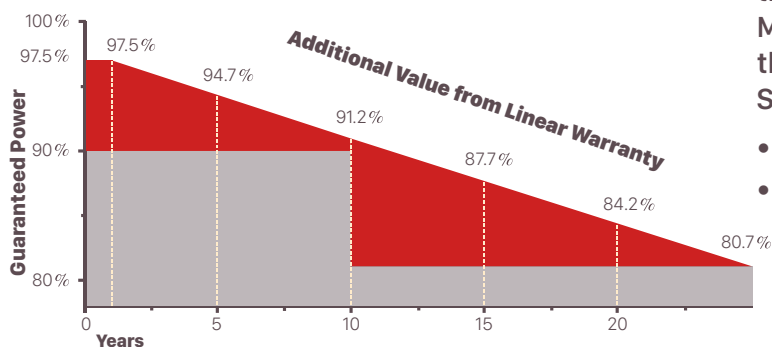

• 97.5% in the first year, thereafter, for years two (2) through twenty-five (25), 0.7% maximum decrease from MODULE's nominal power output per year, ending with the 80.7% in the 25th year after the defined WARRANTY STARTING DATE.

- 12 -year product warranty
- 25-year linear performance warranty

## 72Cells:CST156\*156-M-72-(345~370W)

Electrical Characteristics	CST156*156-M-72-345W		CST156*156-M-72-350W		CST156*156-M-72-355W		CST156*156-M-72-360W		CST156*156-M-72-365W		CST156*156-M-72-370W	
	(STC)	(NOCT)	(STC)	(NOCT)	(STC)	(NOCT)	(STC)	(NOCT)	(STC)	(NOCT)	(STC)	(NOCT)
Maximum Power - Pmax(W)	345 (0/+5W)	255.57	350 (0/+5W)	259.15	355 (0/+5W)	263.37	360 (0/+5W)	265.99	365 (0/+5W)	270	370 (0/+5W)	273.67
Open Circuit Voltage - Voc(V)	46.80±5%	43.3	47.25±5%	43.5	47.46±5%	43.6	47.67±5%	43.8	47.88±5%	44.0	48.09±5%	44.2
Short Circuit Current - Isc(A)	9.56±5%	7.74	9.60±5%	7.79	9.68±5%	7.87	9.76±5%	7.93	9.84±5%	7.99	9.92±5%	8.06
Voltage at Pmax-Vmp(V)	38.40	35.3	38.60	35.5	38.80	35.6	39.00	35.8	39.20	36.0	39.40	36.2
Current at Pmax-Imp(A)	8.99	7.24	9.07	7.30	9.15	7.37	9.24	7.43	9.31	7.50	9.39	7.56
Module Efficiency-ηm(%)	17.80		18.00		18.30		18.60		18.80		19.10	

Mechanical Specifications	
External Dimensions	1960*990/992*40mm
Weight	21.5kg
Solar Cells	mono crystalline 156.75*156.75mm (72pcs)
Front Glass	3.2 mm tempered glass low iron
Frame	Anodized aluminum alloy
Junction Box	IP67
Output Cables	4.0mm <sup>2</sup> , cable lenght:1100mm
Connector	Ningbo Guangzhixing Photovoltaic Technology PV-GZX1500
Mechanical Load/front	a:5400pa b:3600pa
Mechanical Load/back	a:2400pa b:1600pa

Safety factor	1.5
Maximum System Voltage(V)	1500
Maximum Series Fuse Rating(A)	15
STC: Irradiance 1000 W/m <sup>2</sup> , module temperature 25 °C, AM=1.5; Best in Class AAA solar simulator (IEC 60904-9) used, power measurement uncertainty is within +/- 3% NOCT: Irradiance 800 W/m <sup>2</sup> , ambient temperature 20 °C, AM=1.5, wind speed 1 m/s; Best in Class AAA solar simulator (IEC 60904-9) used, power measurement uncertainty is within +/- 3%	

Packing Configuration		
Container	20'GP	40'GP
Pieces per pallet	26	26
Pallets per container	10	24
Pieces per container	260	624

Temperature Characteristics	
Pmax Temperature Coefficient	-0.40 %/°C
Voc Temperature Coefficient	-0.32 %/°C
Isc Temperature Coefficient	+0.05 %/°C
Operating Temperature	-40~85 °C
Nominal Operating Cell Temperature (NOCT)	45±2 °C

### Engineering Drawings

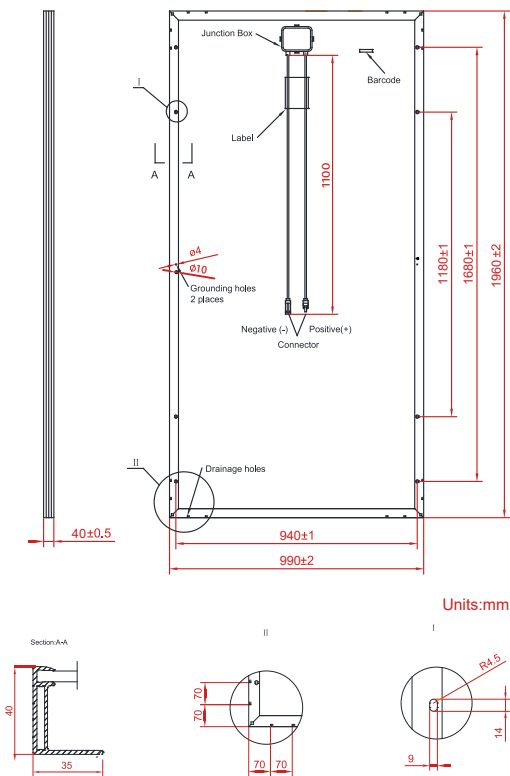

### Temperature Dependence & Electrical Performance

